

Denise Coates Foundation Building

Smart Innovation Hub

room facilities

- Meeting rooms contain presentation equipment
- Boardrooms contain video conferencing equipment

Additional audio visual equipment is available on request.

**Subject to dates rooms can be requested*

| Room Number | Room Name | Room Layout | Room Capacity |
|-------------|-------------------------------------|---------------|---------------|
| SIH.LG.007 | Innovation 1 | Classroom | 20 |
| SIH.LG.008 | Innovation 2* | Hollow Square | 16 |
| SIH.LG.009 | Innovation 3* | Classroom | 21 |
| SIH.LG.011 | Meeting Room 1 | Lounge | 4 |
| SIH.LG.012 | Meeting Room 2 | Lounge | 4 |
| SIH.LG.030 | Lecture Theatre* | Theatre | 208 |
| SIH.LG.031 | Think Lab | Harvard | 61 |
| SIH.LG.033 | Digital Suite* | Computers | 24 |
| SIH.LG.034 | Open Innovation and Animation Space | Lounge | 68 |
| SIH.LG.035 | Executive Boardroom | Boardroom | 20 |
| SIH.LG.036 | Boardroom | Boardroom | 14 |



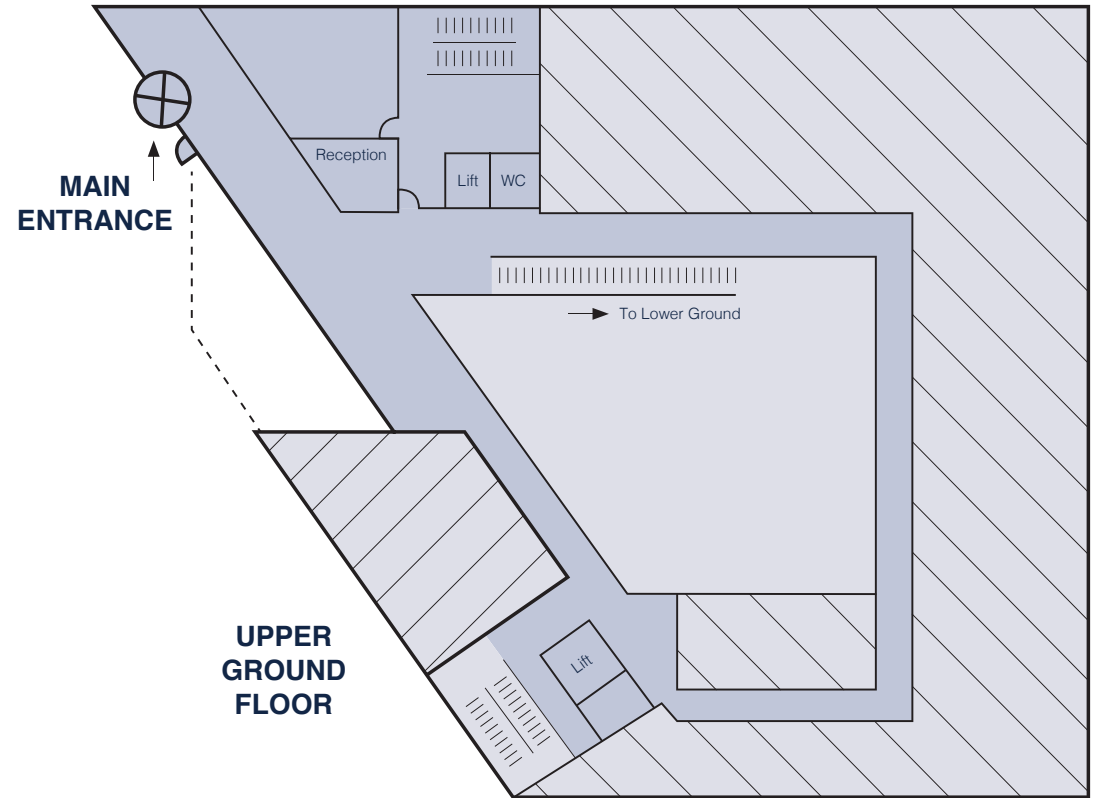
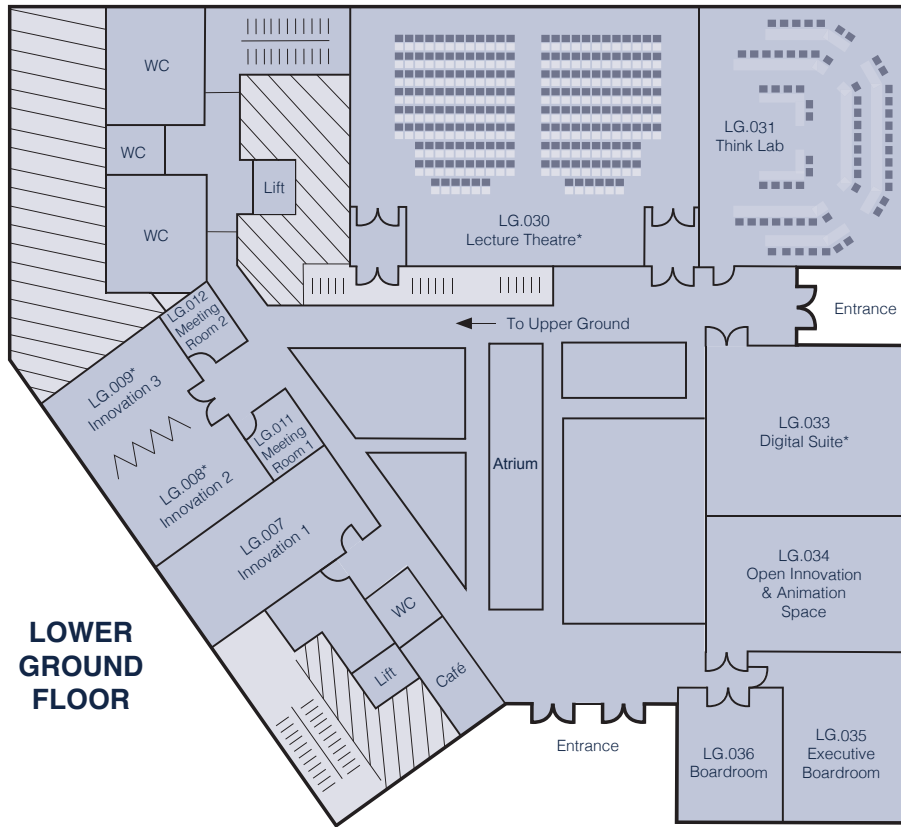

The Keele University Science and Innovation Park Smart Innovation Hub (ref no: 32R17P01691) / Innovation Centre 6, located within the Denise Coates Foundation Building, has been part-funded by the European Regional Development Fund as part of the England Growth Programme 2014-2020, the Midlands Engine and Staffordshire County Council, with support from the Stoke-on-Trent and Staffordshire Local Enterprise Partnership.



Events and Conferencing